

RapidBac™ Vet

TEST PROCEDURES

HOW TO TEST

 **Read all instructions before use**

 **Precautions and Warnings**

- Do not open foil pouch prior to use
- Do not reuse volumetric pipettes, test strips or vials
- Assays sufficient for 10 tests

 **Storage**

- Store at room temperature (10-30°C/ 50-86°F)
- Do not use after expiration date on packaging

Kit Components

- Ten foil pouches containing one RapidBac™ Vet test strip, one test vial, and two volumetric pipettes each.
- One bottle of Assay Buffer (for 10 tests).

Urine Collection

- Cystocentesis • Catheter • Clean catch

Using a Volumetric Pipette

Press firmly on the **TOP** bulb with the tip in the air, then place the pipette tip below the liquid level. Release the bulb slowly to fill cylindrical portion of the pipette. Make sure the entire cylinder is filled with liquid. Transfer the liquid to the assay vial by pressing firmly on the **TOP** bulb.

INTERPRETING RESULTS

Positive Results: Any color development at **Line 1** or **Line 2** indicates the presence of bacteria.

Faint lines are valid results.

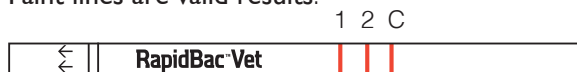

Negative Result: Only **Control Line** develops color – no bacteria detected



Invalid Result: If **Control Line** does not develop color, the result is invalid – repeat test.

STEP BY STEP

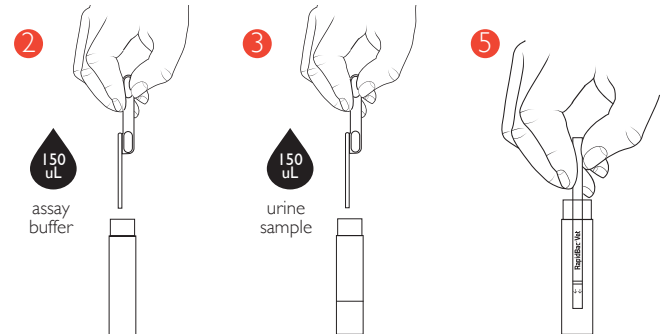

- 1 Open foil pouch and remove contents.
- 2 Using one pipette, add one pipette full of Assay Buffer to test vial. Make sure all liquid is at the bottom of the vial by tapping the vial gently on a flat surface. Wait 2 minutes, swirling test vial occasionally.
- 3 Using the second, clean pipette, add one pipette full of urine sample to the test vial. Swirl to mix.
- 4 Wait 5 minutes.
- 5 Place test strip in test vial with arrows pointing down.
- 6 Wait 10 minutes.
- 7 Remove test strip from vial and read results.



Interpretation: If both **Line 1** and **Line 2** are present, a **Gram-negative** organism has been detected. **Gram-negative** bacterial species known to give this result include: *E. coli*, *Klebsiella spp*, *Citrobacter spp*, *Enterobacter spp*, and *Serratia spp*.

If **Line 2** is present and **Line 1** is absent, the detected organism may be **Gram-positive** or **Gram-negative**. Bacterial species known to give this result include: *Proteus spp*, *Morganella spp*, *Providencia spp*, *Staphylococcus spp*, *Enterococcus spp*, *Actinomyces spp*, and *Actinobaculum spp*.



CONTACT US

www.sensorhealthsciences.com

- 1 888 777 7080 (Office)  info@sensorhealth.com
1 519 621 1515 (Office)  @SensorHealthSciencesVet
1 519 621 8778 (Fax)  Sensor Health Sciences